

**Withwave's 4 way Power Divider** offer frequency range from 698 to 6000 MHz and low insertion loss & VSWR. This divider (PD69860-4-SF) is capable of power handling to 10 Watt

### ■ Features

- 4 Way Type
- SMA Connector (Female)
- Power Handling : 10 Watt

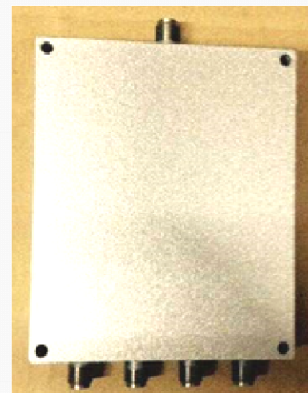

### ■ Specification

Scope	Specification	PD69860-4-SF
Electrical	Impedance	50 Ohm
	Freq. range	698 to 6000 MHz
	Insertion Loss	<2.8 dB
	Isolation	>15 dB
	VSWR	<1.8
	Power Handling	10 W
Mechanical	Port Connector	SMA (Female)
	Operation Temperature	-30 to 65 degree

### ■ Drawing

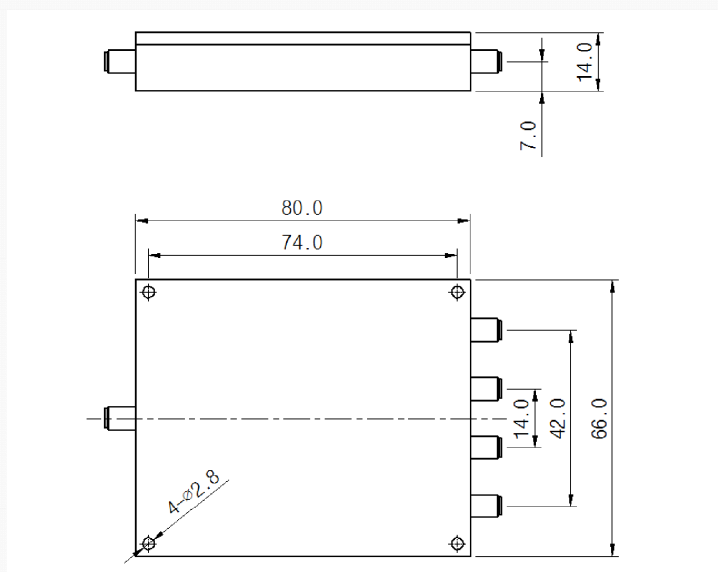

Unit : mm